

# PAREX THERM ONTO TIMBER FRAME

BOARD FIXINGS



# PTTNC0701

This detail is for general guidance only and is not project specific. Always refer to the project architect details and the PAREX project specific specification.

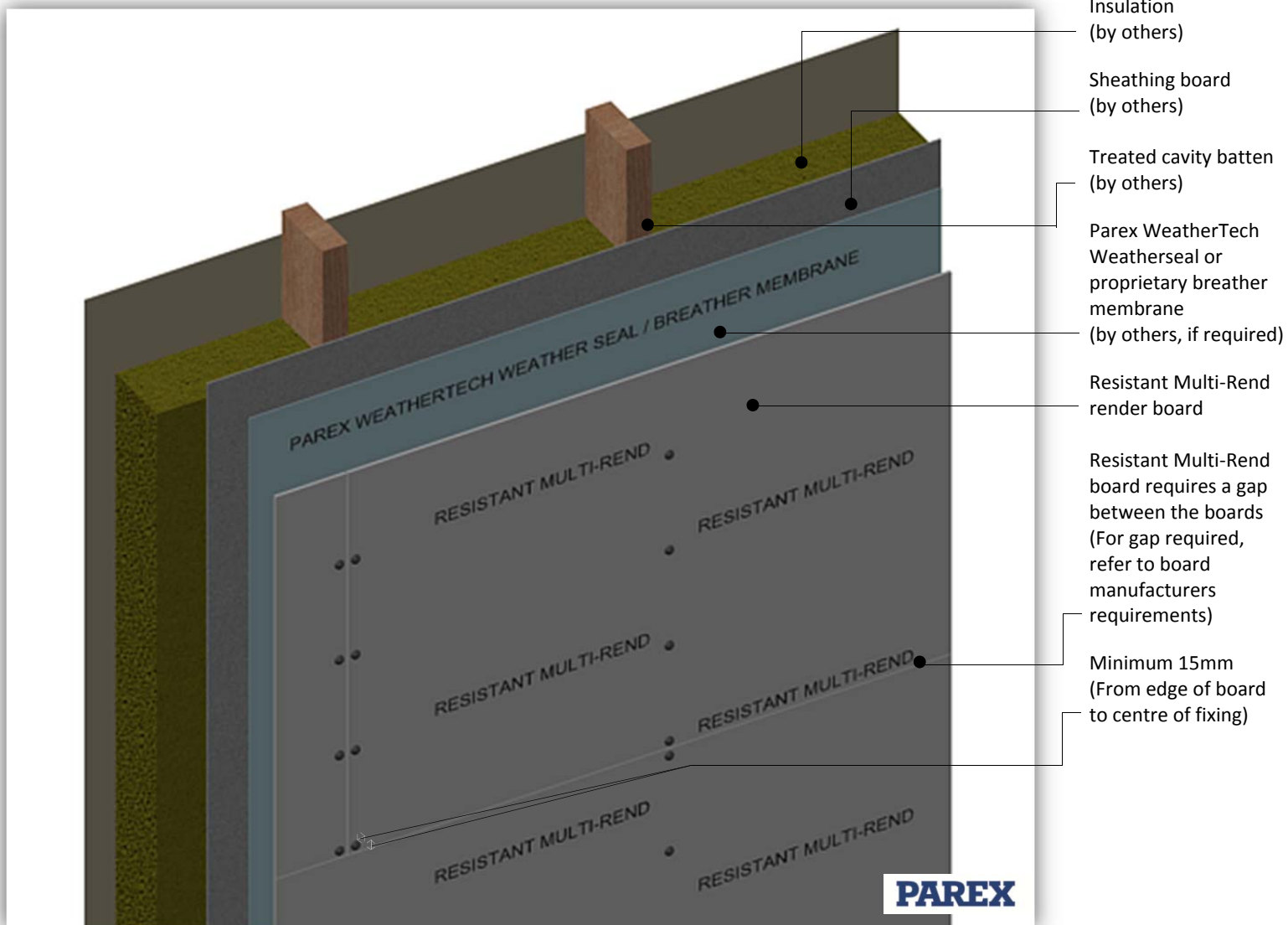

To ensure you meet with project specific requirements, consult the Resistant Multi-Rend render board fixing requirements. All fixings to be Resistant Multi-Rend non-corrosive and of sufficient length and performance. The fixing distances shown are for guidance only and may vary subject to the building design. If you are unsure please ask first.

System: PAREX THERM onto Timber Frame  
Application: PAREX THERM system onto Resistant Multi-Rend render board – Board Fixing  
Drawing No: PTTNC0701  
Date: December 2015

## PAREX

The information provided in this document results from our knowledge of the products and our experience. On-site results may vary, in particular according to the product application methods adopted. Where application methods not covered by this document are used, customers must request specific additional information and/or carry out a representative test before using the products. The above-mentioned information in no way constitutes a warranty relative to the use of the products. Our general terms and conditions of sale shall prevail, in any event, on the information provided in this document. Prior to application, customers and users are requested to check that they have the latest version of this document.