

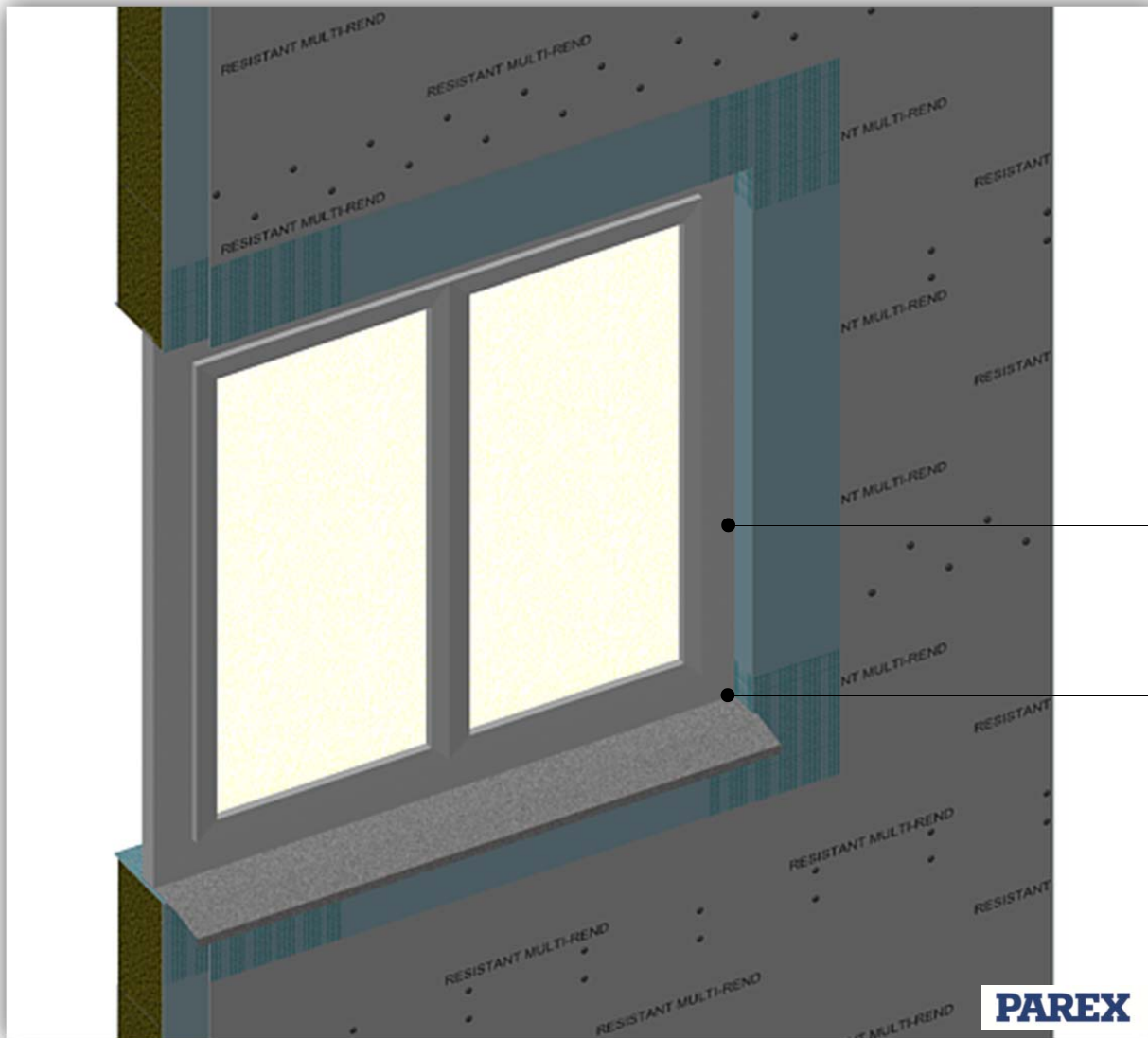

This detail is for general guidance only and is not project specific. Always refer to the project architect details and the PAREX project specific specification.



Fully seal the window with an appropriate mastic or silicone sealant to ensure the frame is fully weatherproof against water ingress

The window cill detail will vary subject to window type. For any special requirements contact PAREX.

The general principles of this detail will apply to all forms of openings. For unusual applications contact PAREX for additional guidance.

System: PAREX THERM onto Steel Frame

Application: Window installation 3 of 4 – Window Installation

Drawing No: PTSNC0509A (In addition to this detail please also refer to details – PTSNC0509 1 to 4)

Date: December 2015