

# PAREXDIRECT CAVITY ONTO TIMBER FRAME

# PDTC0409A

WINDOW PROCEDURE 4 OF 5



This detail is for general guidance only and is not project specific. Always refer to the project architect details and the PAREX project specific specification.

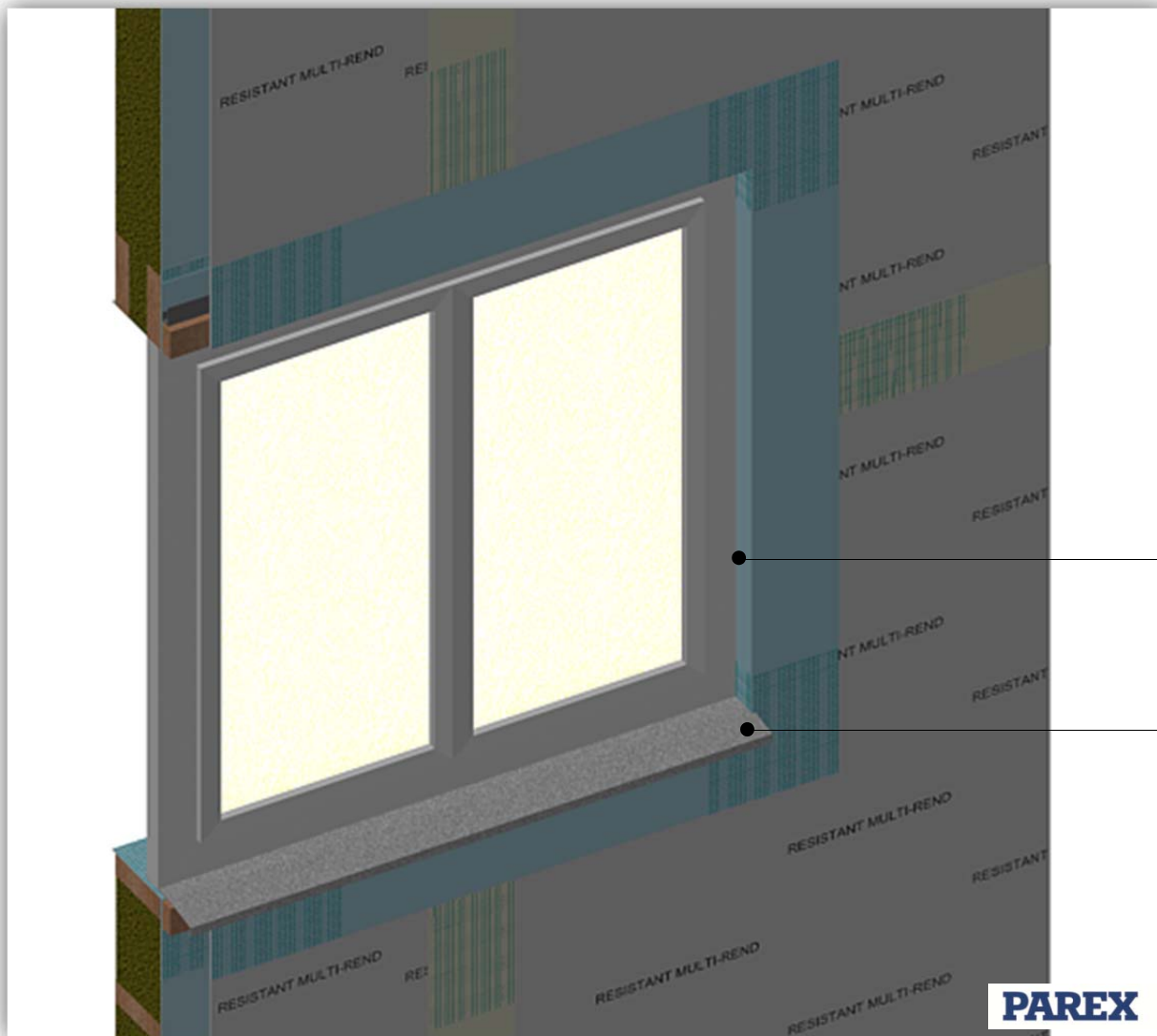

Fully seal the window with an appropriate mastic or silicone sealant to ensure the frame is fully weatherproof against water ingress

The window cill detail will vary subject to window type. For any special requirements contact Parex.

The general principles of this detail will apply to all forms of openings. For unusual applications contact Parex for additional guidance.

System: PAREXDIRECT onto Timber Frame  
Application: Window installation 4 of 5 – Window Installation  
Drawing No: PDTC0409A (In addition to this detail please also refer to details – PDTC0409 1 to 5)  
Date: November 2015

## PAREX

The information provided in this document results from our knowledge of the products and our experience. On-site results may vary, in particular according to the product application methods adopted. Where application methods not covered by this document are used, customers must request specific additional information and/or carry out a representative test before using the products. The above-mentioned information in no way constitutes a warranty relative to the use of the products. Our general terms and conditions of sale shall prevail, in any event, on the information provided in this document. Prior to application, customers and users are requested to check that they have the latest version of this document.