

# PAREXDIRECT CAVITY ONTO STEEL FRAME FRAME

# PDCS0209A

WINDOW PROCEDURE 2 OF 5



This detail is for general guidance only and is not project specific. Always refer to the project architect details and the PAREX project specific specification.

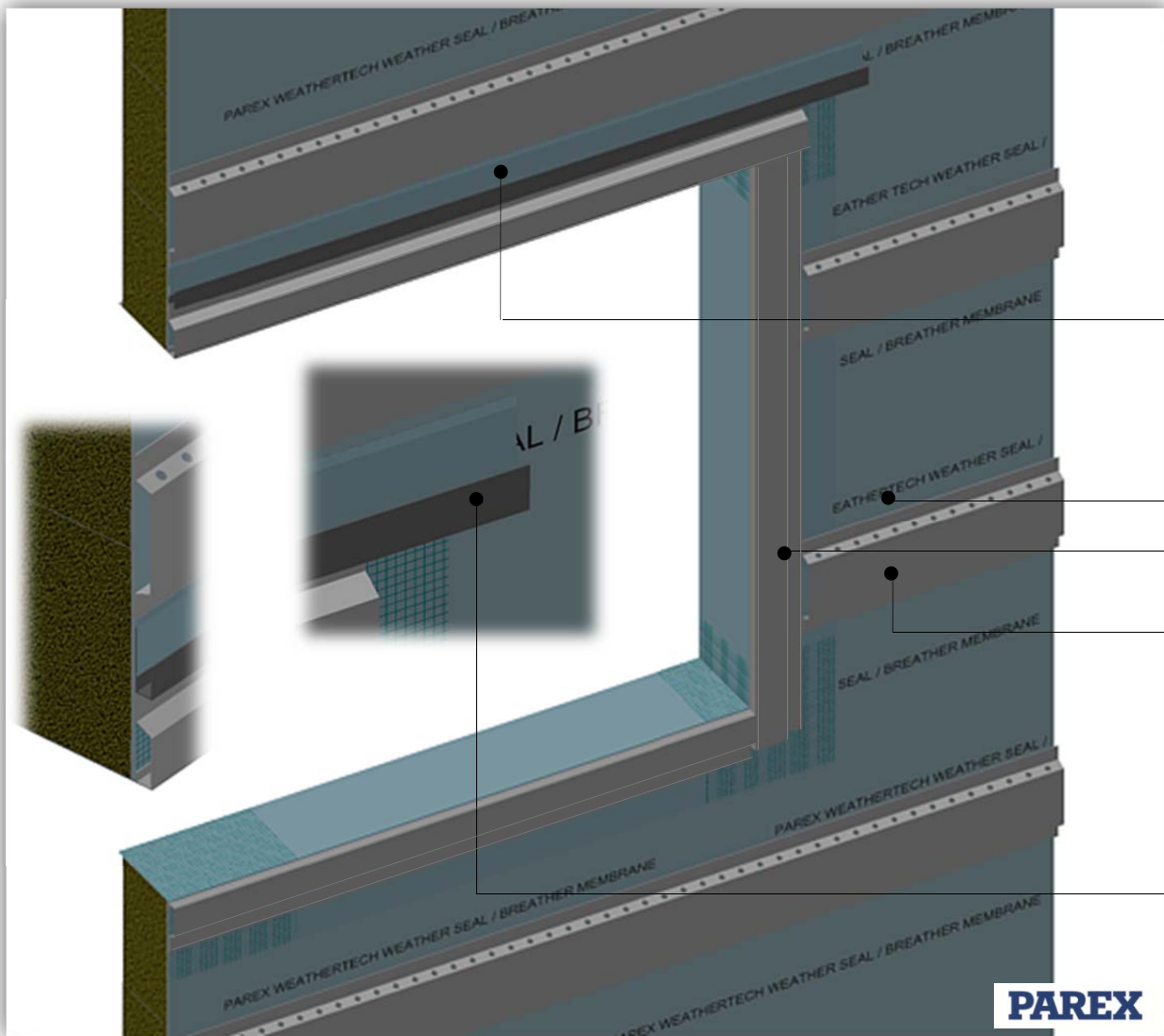

Ensure the WeatherTech Weatherseal fully seals the breather membrane directly into the window / door head cavity deflection channel to prevent moisture gaining access into the building

Parex Weather Tech Weatherseal or proprietary breather membrane (by others, if required)

Cavity closer

Render board support rail

Aluminum window / door head drainage channel positioned at a slight angle (10mm fall) and fixed above the cavity closer with a minimum 50mm overhang at both ends

The general principles of this detail will apply to all forms of openings. For unusual applications contact Parex for additional guidance.

System: PAREXDIRECT onto Steel Frame

Application: Window installation 2 of 5 - Fitting of the cavity closers and window / door head cavity drainage channel

Drawing No: PDCS0209A (In addition to this detail please also refer to details – PDCS0209 1 to 5)

Date: November 2015

**PAREX**

The information provided in this document results from our knowledge of the products and our experience. On-site results may vary, in particular according to the product application methods adopted. Where application methods not covered by this document are used, customers must request specific additional information and/or carry out a representative test before using the products. The above-mentioned information in no way constitutes a warranty relative to the use of the products. Our general terms and conditions of sale shall prevail, in any event, on the information provided in this document. Prior to application, customers and users are requested to check that they have the latest version of this document.