



# multi-pro XS

RESISTANT

BUILDING PRODUCTS (2025) LTD

RESXSG0310/001



## Fixing Guide

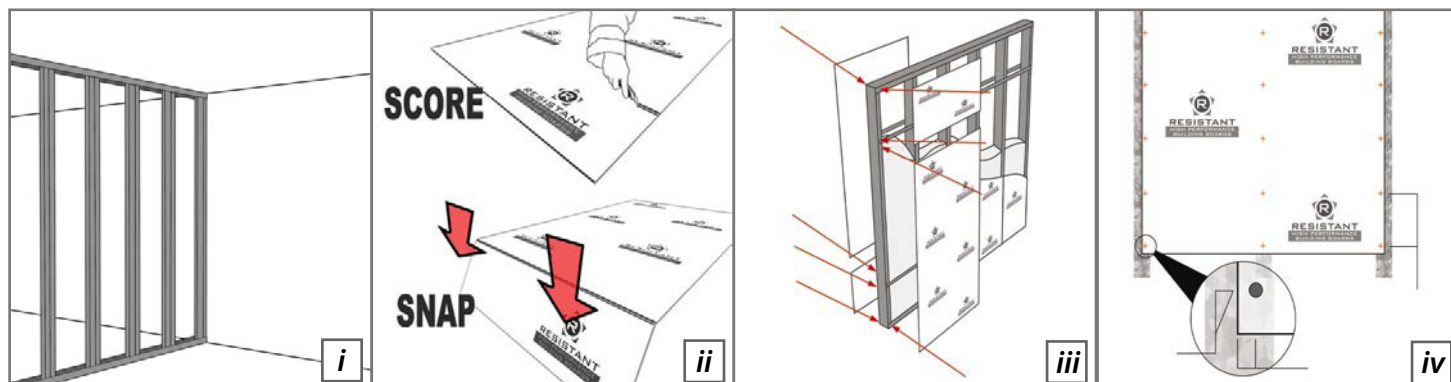

### PREPARATION

#### Studwork

Resistant boards can be attached to either timber or steel studwork, depending on the nature of the job. The layout of the partition is similar for both systems (figure i).

When connecting to timber structure always ensure that the timber has been kiln dried. Never locate adjacent or fix our boards to timbers which have a moisture content in excess of 16%.

#### Fixings

For service class 3 (external) applications, stainless steel type screws or nails must be used.

For service class 2 (cavity condition) applications, stainless steel or electro galvanised coating (minimum 12 microns) can be selected.

#### Cutting

In the case where boards may need to be custom cut to size, sheets are easily cut using the 'Score & Snap' method (figure ii). Mark out the desired size on the board with a pencil and rule. Score along the with a utility knife, making sure to slice the glass fibre mesh, then simply press the board downwards snapping it at the 'Score & Snap' line. Smooth and tidy up the edges with a light abrasive. For areas of fittings and fixtures, cut outs should be done before installing the board.

Resistant recommend the use of a dust mask and eye protection at all times.

#### Finish

Resistant Multi-pro XS can be faced with Plastisol Steel, GRP, acrylic based render systems or brick slips. This provides any designer with unlimited options.

### FIXING

#### Wall Attachment - Typical Non-structural

Resistant board are attached onto the vertical studs in a symmetrical fashion each side of the partition ( figure iii ). They should be attached vertically on the subframe, with fixings at 300mm maximum centres vertically and 600mm maximum centres horizontally. Space fixings a minimum of 10mm from the edge and 20mm from the corner of the board ( figure iv & large diagram page 2 ).

When fixing, start at the centre and work outwards to prevent distortion within the boards. Boards should be offset so that four corners never meet at one point.

Boards can be closely butt jointed for internal wall lining. Avoid fitting with 4 corners meeting.

For timber frame external racking panel manufacture, gun nail fixing centres are determined by the structural engineer.

Commonly a 2mm fitting gap is left between boards during external racking timber frame panel manufacturing.

A minimum of 6mm gap should be left above the finished floor level of load bearing panels to accommodate any settlement of the timber frame.

#### Information For Composite Cladding Panels

When Multi-pro XS is selected as the core substrate component of laminated / bonded cladding panel it is the responsibility of the cladding panel specifier & building designer to:

- Decide on the need to incorporate a balancer laminate
- Detail the fixing arrangement - it is possible closer fixing centres will be required. Additional use of a suitable adhesive may also be incorporated.
- Ensure when fixing through the steel face that excessive force is not applied. Fixing heads should not be delivered past flush with the cladding panel surface. Fixing indentation beyond flush will damage the multi-pro XS core and risk buckling of the cladding panel.
- Seal all cladding panel edges and fixing heads (consult steel sheet manufacturer for their input). Provide clear fitting instruction to prevent moisture ingress into panel.



multi-proXS

RESISTANT  
BUILDING PRODUCTS (2025) LTD

RESXSFG0310/002



## Fixing Guide

Minimum  
10mm

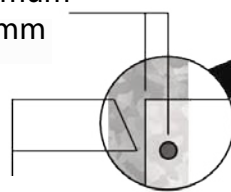

Minimum  
20mm

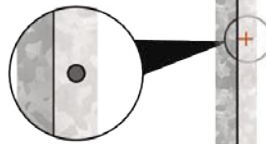

Maximum  
300mm

Maximum  
600mm

Please note guidance stated for vertical fixing centres is maximum for use as an internal wall lining. Project engineer to specify fixing distances for when board is used as a structural racking sheathing board or as a component of a bonded cladding panel.

### Timber Frame Gun Nail

Stainless Steel or  
electro galvanised  
(min 12 microns)

2.8 x 50mm



### Internal Timber Stud Typical Screw

4.8 x 42mm



Please note that selection of an appropriate fixing type suitable for the end application is the responsibility of the building designer. Our guidance is to use stainless steel fixings for all external (service class 3) applications. For fixing of plastisol faced steel external cladding panels a fixing type incorporating a flexible washer to prevent moisture ingress at fixing head location is recommended.

