

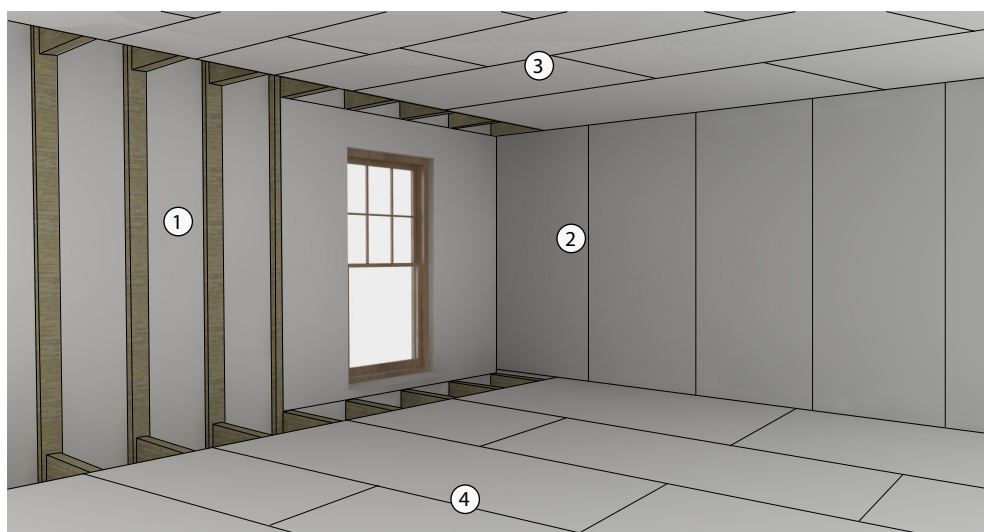

Multi-Pro XS 6.5mm is a medium density magnesium oxide panel which has been developed to provide the system build and off-site construction markets with a lightweight fire rated wall panel system. Multi-Pro XS 6.5mm is tested to BS EN 594 (racking), is Non-combustible Euro Class A1, offers temporary weather resistance during construction phase, has a low environmental impact and provides a stable substrate to bond various finishes too.

## OPEN PANEL CONSTRUCTION



### Key

1. Open Panel
2. Closed Panel / Internal liner
3. Ceiling Liner
4. Under Structural Decking Board

### Suitable Applications for 6.5mm as listed within STA Product Paper 4 version 2 October 2013

- 4.1.1 Floor type F4 Page 11.
- 4.1.1 Floor type F6 Page 12.
- 4.2.1 Wall type W3 and W4 Page 14.
- 4.3.2 Wall types W5, W6, W7 & W8 Page 16.
- 4.4.1 System wall assemblies Page 19 S3, S4 & S5.

**Figure 1. (As tested)**

**This Open Panel Construction as shown in figure 1 has recently been tested by the BRE for the Structural Timber Association (STA) small room tests compliance to category C. It consisted of 140 x 38mm untreated studs nailed at 600mm c/c to 1200 x 2440 x 6.5mm Multi-Pro Magnesium Oxide board with a breather membrane externally. Full video of fire test at [www.resistant.co.uk](http://www.resistant.co.uk).**

## MANUFACTURE

RESISTANT Multi-Pro XS 6.5mm is manufactured using inorganic substances, SiO<sub>2</sub>, CaCO<sub>3</sub>, MgO, MgCl<sub>2</sub>, and alkaline resistant fibreglass mesh. Why alkaline resistant - because MGO products have a high alkalinity once cured and durability is assured with alkaline resistant mesh.

The product is naturally cured using no energy through cold fusion unlike similar competitive products on the market which use autoclaving technology. This ensures that RESISTANT Multi-Pro XS 6.5mm has a relatively low impact on the environment. Multi-Pro XS 6.5mm achieves its superior strength and flexibility by the introduction of four layers of alkaline resistant fibre glass mesh. Consistent high quality of the product is maintained and monitored through a sophisticated digitally controlled process to ensure a superior finished board always reaches our commitment to quality assurance.

## TYPICAL USES

It is ideal for applications requiring a combination of these properties, for example:

- Open & Closed Panel Timber Frame. (as referenced in STA Product Paper 4).
- Racking board Cat 1 equivalent when nailing @ 100mm centres.
- Park Homes Sheathing.
- Standard Frame Sheathing board.