

Why Choose 20-20 Fibre Cement

20-20 Fibre Cement Board has been developed by Resistant Building Products to provide our customers with one tough board for two demanding applications. Rendering & LGS Fire Resistant Sheathing.

RENDER CARRIER & EWI SUBSTRATE BOARD



HIGH STRENGTH - 13 MPa MOR (bending strength) in wet condition



HIGH IMPACT - Strong enough to sustain heavy blows



WEATHER RESISTANT - Highest possible Cat A durability rating BS EN 12467



LIGHT GAUGE STEEL FRAME FIRE RESISTANT SHEATHING BOARD



A1 Non-combustible. Won't add fuel to a fire.



60 & 90 minutes fire resistance wall - 9mm board tested in both directions.
"See our Passive Fire Guide for full details"

TESTING & CERTIFICATION



BS EN 13501-1



BS EN 1364-1 NLB Steel Stud Partition



BS EN 12467 CATEGORY A



Fixing & Fitting information

Resistant 20-20 boards are used in many varied applications that may require fitting gaps, expansion gaps or butting edge joints tightly. Our generic fitting guidance is summarised here:

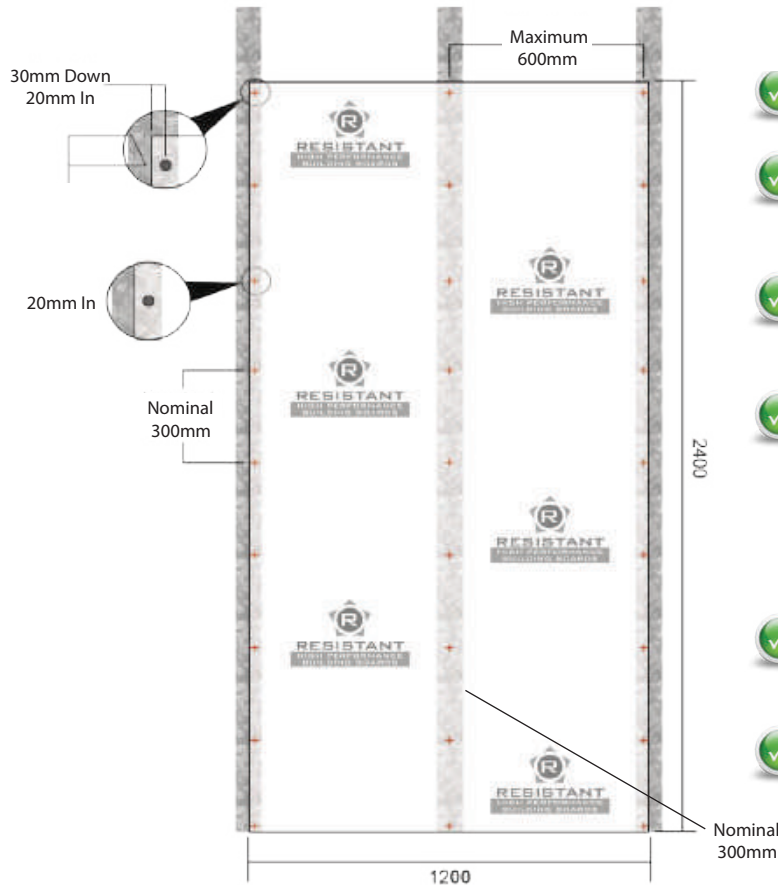

- ✓ Boards should be offset so that 4 corners never meet
- ✓ Space fixings a minimum of 30mm down from corners & 20mm in from edges
- ✓ Use stainless steel fixings in all service class 3 (external applications such as render carrier) conditions
- ✓ Leave a 4mm fitting gap all around when fitting as a render carrier
Leave a 2mm fitting gap all around when fitting as a sheathing board
Board joints can be filled with jointing compound/ sealant & covered with tape as required
- ✓ Please note a fitting gap is not the same as a movement joint. Allowance for movement should be detailed by the building designer
- ✓ Breather membrane required when used as sheathing



Timber Stud

Typically countersunk head
4.8 x 42mm



Metal Stud

Typically wing tipped & self drilling
4.8 x 38mm

Available Board Sizes	Weight Per Board
1200 x 2400 x 9mm	36kg
1200 x 2400 x 12mm	48kg

Uses & Applications

- Fire resistant steel frame sheathing
- Direct render carrier board
- EWI sheathing board
- Wall linings in high traffic locations and areas prone to abuse

**PROVIDING SOLUTIONS
ACROSS THE BOARD.**