

### Why Choose 20-20 Fibre Cement

20-20 Fibre Cement Board has been developed by Resistant Building Products to provide our customers with one tough board for two demanding applications. Rendering & LGS Fire Resistant Sheathing.

### RENDER CARRIER & EWI SUBSTRATE BOARD



**HIGH STRENGTH** - 13 MPa MOR (bending strength) in wet condition



**HIGH IMPACT** - Strong enough to sustain heavy blows



**WEATHER RESISTANT** - Highest possible Cat A durability rating BS EN 12467



### LIGHT GAUGE STEEL FRAME FIRE RESISTANT SHEATHING BOARD



**A1 Non-combustible.** Won't add fuel to a fire.



**60 & 90 minutes fire resistance wall** - 9mm board tested in both directions.  
"See our Passive Fire Guide for full details"

### TESTING & CERTIFICATION



BS EN 13501-1



BS EN 1364-1 NLB Steel Stud Partition



BS EN 12467 CATEGORY A



# Fixing & Fitting information

Resistant 20-20 boards are used in many varied applications that may require fitting gaps, expansion gaps or butting edge joints tightly. Our generic fitting guidance is summarised here:

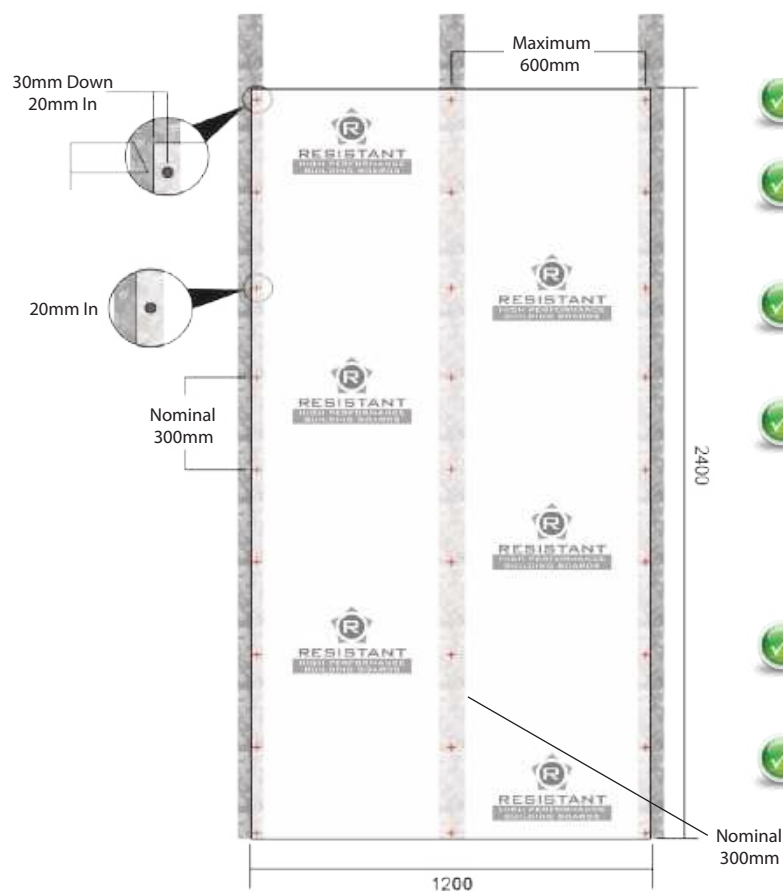

- Boards should be offset so that 4 corners never meet
- Space fixings a minimum of 30mm down from corners & 20mm in from edges
- Use stainless steel fixings in all service class 3 (external applications such as render carrier) conditions
- Leave a 4mm fitting gap all around when fitting as a render carrier  
Leave a 2mm fitting gap all around when fitting as a sheathing board  
Board joints can be filled with jointing compound/sealant & covered with tape as required
- Please note a fitting gap is not the same as a movement joint. Allowance for movement should be detailed by the building designer
- Breather membrane required when used as sheathing



## Timber Stud

Typically countersunk head  
4.8 x 42mm



## Metal Stud

Typically wing tipped & self drilling  
4.8 x 38mm

## Uses & Applications

Fire resistant steel frame sheathing

Direct render carrier board

EWI sheathing board

Wall linings in high traffic locations and areas prone to abuse

Available Board Sizes	Weight Per Board
1200 x 2400 x 9mm	36kg
1200 x 2400 x 12mm	48kg

**PROVIDING SOLUTIONS  
ACROSS THE BOARD.**