



## Technical Data Sheet

Gypsum and Plywood products are commonly used as a tiling substrate in showers where stud walls are common. Both these substrates are susceptible to deterioration if moisture penetrates through a crack or joint on a tiled wall or floor. Constant moisture penetration will cause both products to degrade over time and result in

moisture related problems. When MoistSure is used and installed as per the recommended guidelines, these problems should not occur. MoistSure is a water resistant backer board that will not swell, rot or degrade over time and can accept a number of finishes including wall and floor tiles.

### Bathroom Detail

high performance  
durability

#### Key:

- 1 Top Rail
- 2 Strap for Attachment
- 3 **12mm MoistSure**
- 4 Support for fixture Attachment
- 5 GRP angle strip
- 6 Lower Rail
- 7 **6mm MoistSure**
- 8 Tile Adhesive
- 9 Joint Filler
- 10 Wall Tiles
- 11 Bathroom Furniture
- 12 Floor Tiles
- 13 18mm Surefloor
- 14 **12mm MoistSure**
- 15 Floor Joist

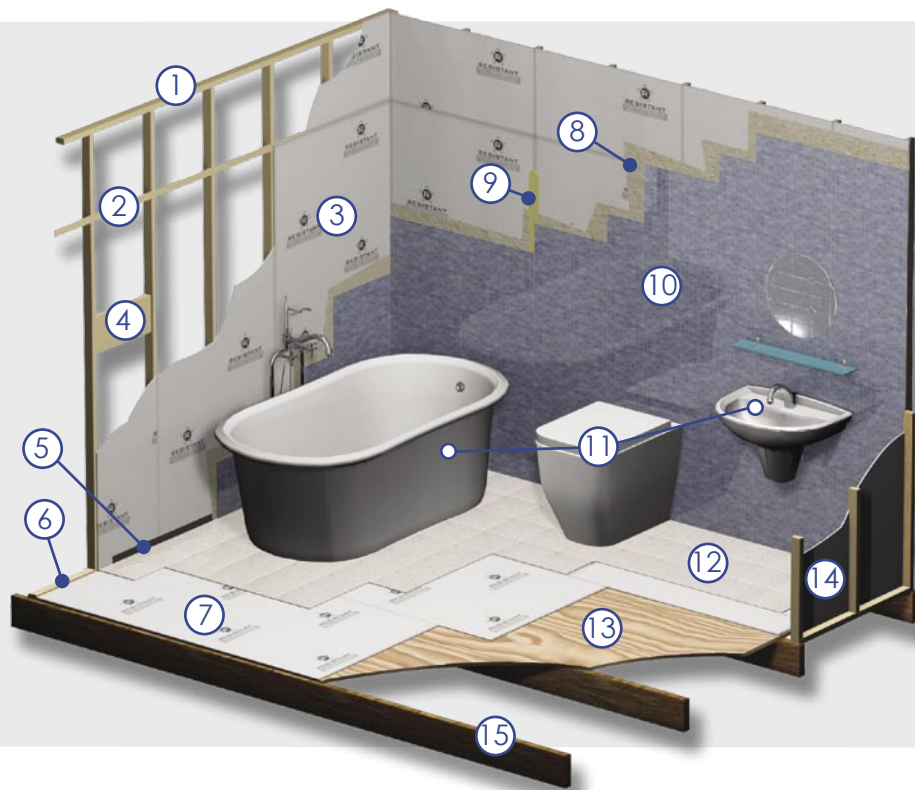

## MANUFACTURE

Resistant MoistSure is manufactured using inorganic substances, natural silicates CaCO<sub>3</sub>, MgO, MgCl<sub>2</sub>, and alkaline resistant fibreglass mesh.

The product is naturally cured using no energy through cold fusion unlike similar competitive products on the market which use autoclaving technology. This ensures that Resistant MoistSure has a relatively low impact on the environment. MoistSure achieves its superior strength and flexibility by the introduction of two layers of alkaline resistant glass fibre mesh. Consistent high quality of the product is maintained and monitored through a sophisticated digitally controlled process to ensure a superior finished board always reaches our commitment to quality assurance.

## TYPICAL USES

It is ideal for applications requiring a combination of these properties, for example:

Tile Backer Board  
Internal Wet areas:  
Kitchen  
Bathroom  
Swimming Pool  
Areas of high moisture



## Technical Data Sheet

### Technical SPECIFICATION

Test Subject	Test	Result
Density Dry (ex works)		1050 kg/m <sup>3</sup> (+/- 10%)
Modulus of Rupture	BSEN 310	20 Nmm <sup>2</sup>
Modulus of Elasticity	BSEN 310	4.54 Nmm <sup>2</sup>
Impact Strength (Brinell)		34 Nmm <sup>2</sup>
Vapour Permeability	BSEN 12086	100 mg/m <sup>2</sup> /h
Thermal Conductivity at 50°	BSEN 594	0.26 w/m <sup>0</sup> k
Fire Test	A1 Euroclass	Class Non-Combustible
Change in thickness (After immersion in water)	BSEN 317	0 - 0.1% Nmm <sup>2</sup>
Tensile Strength (Perpendicular to plane)	BSEN 319	2.11 Nmm <sup>2</sup>
Screw Withdrawal Strength	BSEN 320	1.15 KN
Cyclic tests in humid conditions	BSEN 321	
Average Thickness Swelling	BSEN 321	0
Average Tensile Strength	BSEN 321	2.04 Nmm <sup>2</sup>
Moisture Content	BSEN 322	3.6%

### DIMENSIONS

RESISTANT Multi-Pro is supplied as a rectangular board with square edges and white in colour.

Thickness: 3 - 6 - 9 - 12 mm  
 Sizes: 1200 x 2400 / 3000 mm

Special size requirements and thicknesses are also available upon request depending on quantity.

### TOLERANCES

Length and Width: + / - 2mm  
 Thickness: + / - 0.2mm  
 Edge Straightness: 1mm / metre



## Technical Data Sheet

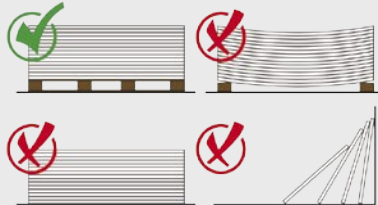

RESISTANT boards should be stored flat, raised from the ground on a pallet, in dry conditions indoors and be under cover. Boards should not be leant upright for long periods of time

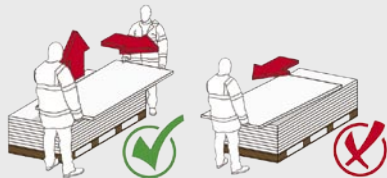

Boards should always be lifted by 2 people and not dragged across each other to prevent unnecessary scratching or damage

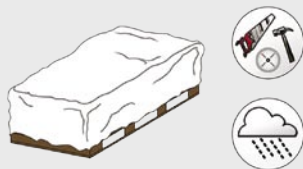

Any moisture allowed to infiltrate between the sheets will cause permanent surface staining. They should be protected from the weather and other trades on site at all times



Boards should be carried on edge and extra precaution should be taken to protect the visible front edge and corners

## SUPERIOR ATTRIBUTES

Apart from accepting a variety of painted/polished finishes, RESISTANT boards provide an excellent compatible surface to a wide range of finishing materials i.e. paints, tiles, veneers, laminates or indeed any finishing option that comes to the creative mind of an architect or interior designer. The acceptance of RESISTANT in the highly competitive international market stands testimony to its superior attributes



### Fire Rated, Non-Flammable , Non-Combustible

*Non-Combustible to BS 476 Part 4  
BS EN ISO 1182 - Euro Class A1*



### Thermal Insulation Properties

*Provides a high level of thermal movements during hot and cold cycles (Thermal Shock)*



### Impact Resistant

*An ability to withstand abuse, including surface impact - 34 N/mm*



### Low Carbon Manufacturing Process

*A natural cured process with a chemical reaction using low levels of heat and a lengthy drying out stage*



### Moisture & Water Resistant

*RESISTANT boards will not physically deteriorate when subjected to water or moisture.*



### Sound Insulation

*Provides excellent sound insulation for walls, floors and ceilings*



### Rodent Resistant

*Resistant to rodent infestation like mice, rats and insects*



### Easy and Fast to work

*Easy and simple to prepare and attach. Rough surface allows application of renders or direct paint / wallpaper*



### Mould Resistant

*Unlike paper faced/wood based products, RESISTANT does not contain cellulose, limiting mould growth*



### Breathability

*Ensures a healthy, durable working building with a natural ability to absorb and release moisture*



### Chemically Stable

*Produced from natural inorganic raw materials, resulting in a strong, durable chemically stable board*



### Non-Hazardous to health

*Will not cause harm to persons and/or the environment. Produced without asbestos or other inorganic fibres*