

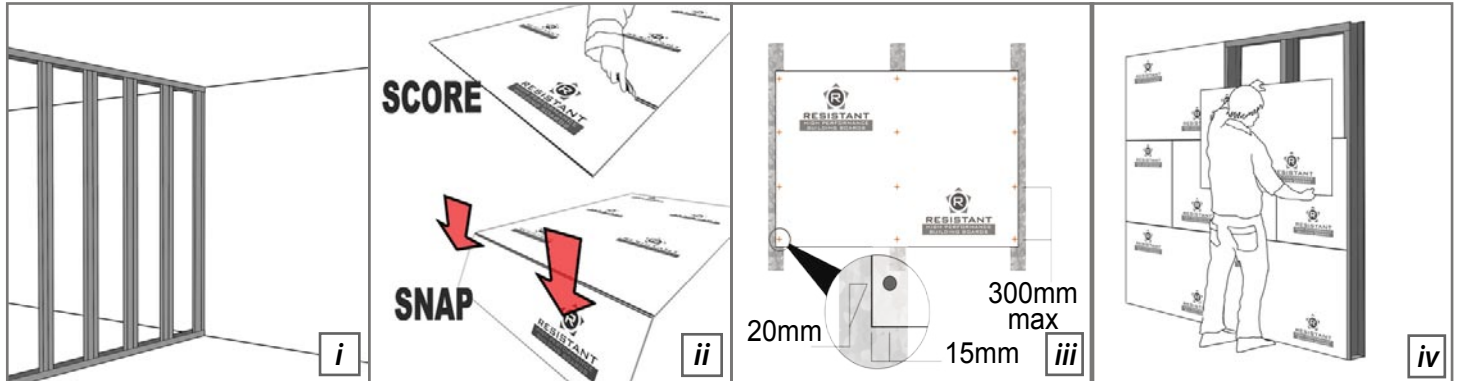

Fixing Guide



PREPARATION

Studwork

MoistSure boards can be attached to either timber or steel studwork, depending on the nature of the job. Steel studwork has the advantages in that it is lighter, generally faster to install and has better acoustic properties. The layout of the partition is similar for both systems. (figure i)

Fixings

Stainless, Phosphate or galvanised steel screws should be chosen, at all times. Screws should be attached commencing at the centre and working outwards towards the edges.

Moist-Sure Board

MoistSure boards come in 2 sizes suitable for floors and walls.

Wall boards measure 1200mm x 800mm x 12mm and so vertical studs should be placed at 600mm centres. There are no need for horizontal studs, as the boards can carry heavy loads without additional support.

Floor boards measure 1220 x 1220 x 6mm.

Cutting

In the case where boards may need to be custom cut to size, sheets are easily cut using the 'Score & Snap' method (figure ii). Mark out the desired size on the board with a pencil and rule. Score along the mark with a utility knife, making sure to slice the glass fibre mesh, then simply press the board downwards snapping it at the 'Score & Snap' line. Smooth and tidy up edges with a light abrasive. For areas of fittings and fixtures, cut-outs should be done before installing the board. RESISTANT always recommend the use of a dust mask and eye protection.

FIXING

Wall Attachment

MoistSure boards are attached onto the vertical studs in a symmetrical fashion each side of the partition. They should be attached horizontally on the subframe, with fixings at 300mm maximum centres vertically and 600mm maximum centres horizontally. Space fixings a minimum of 15mm from the edge and 20mm from the corner of the board (figure iii). When fixing, start at the centre and work outwards to prevent distortion within the boards. Boards should be offset so that four corners never meet at one point (figure iv). If there is a chance that there could be movement in the stud or building then fix further boards allowing a 4mm gap between edges. A 6mm gap should be left above the finished floor level to allow for setting of the frame or movement. When fixing onto Timber stud, boards should be pre-drilled and holes oversized to allow for movement in the frame.

Floor Attachment

Ensure sub-floor is not damaged and replace if necessary. Make certain there is a clean and even surface before laying MoistSure, staggering all MoistSure board joints ensuring they don't align with Sub-Floor joints. Never allow four corners of boards to meet at one point. Apply an even layer of Tile adhesive, with a suitable trowel, to the subfloor before setting MoistSure firmly and evenly in place. Secure one board at a time, fixing screws at 300mm centres ensuring nail heads are flush with the surface (figure v). **MoistSure is suitable for underfloor heating.**

* Please refer to 'Fixing Detail' for further information

Tanking Detail

A 6mm gap is left between the bottom of the board and the level of the floor; this is filled with a high modulus water resistant flexible adhesive (figure vi). In and around the shower tray area and wet rooms MoistSure should be tanked with a 'Larsen' tanking system before tiling.



Fixing Guide

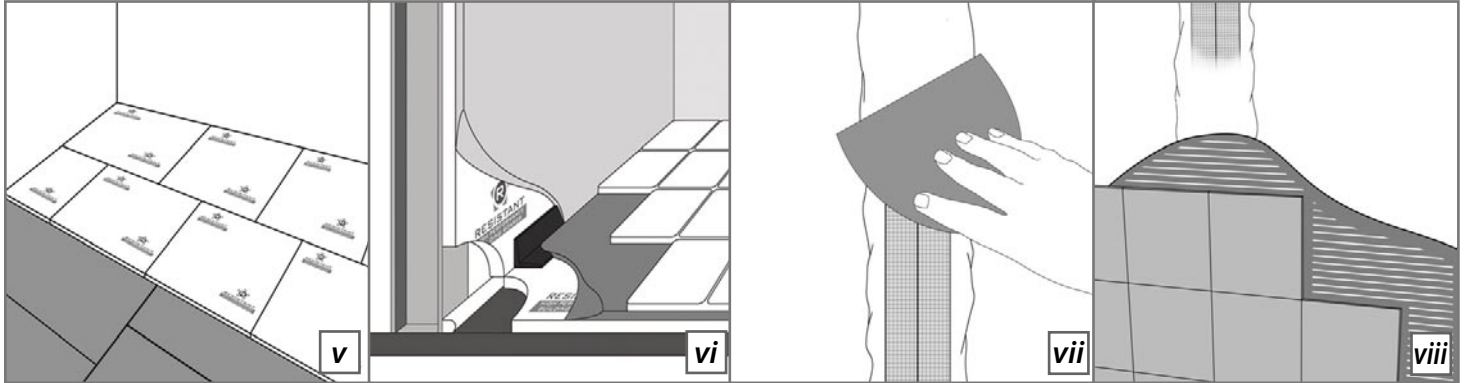

FINISH

MoistSure boards have an attractive smooth finish surface that is immediately ready to receive most forms of decoration with little or no further preparation. There is no need for plastering, as the board can immediately accept paint, wallpaper or a tiling substrate.

Sheet Jointing & Taping

Before applying the final finish layer, the joints should be embedded with a flexible tile adhesive and 50mm alkaline resistant tape to provide extra strength (figure vii).

Tiling

Boards should be sealed on all sides with a Larsen acrylic primer. It is recommended to use Larsen flexible S1 cement based tile adhesive on Walls and Floors. Apply tile adhesive in accordance with the manufacturer's guidelines. Bed the tiles as per good building practice, allowing normal spacing to grout once the bedding adhesive is dry (figure viii).

Paint / Wallpaper

Boards can be painted with emulsion or oil based paints. Advice from coatings' manufacturers regarding surface preparation, sealing and finish coat should be adhered to (figure ix).

Fixtures & Fittings

When attaching heavy objects, all fixings should be made directly into studs or into a nogging fixed firmly between the studs.

RESISTANT recommend using MoistSure throughout the bathroom, not only in shower / wet areas. This will help with the continuing battle against mould and mildew and help to extend the longevity of your bathroom.



Fixing Guide

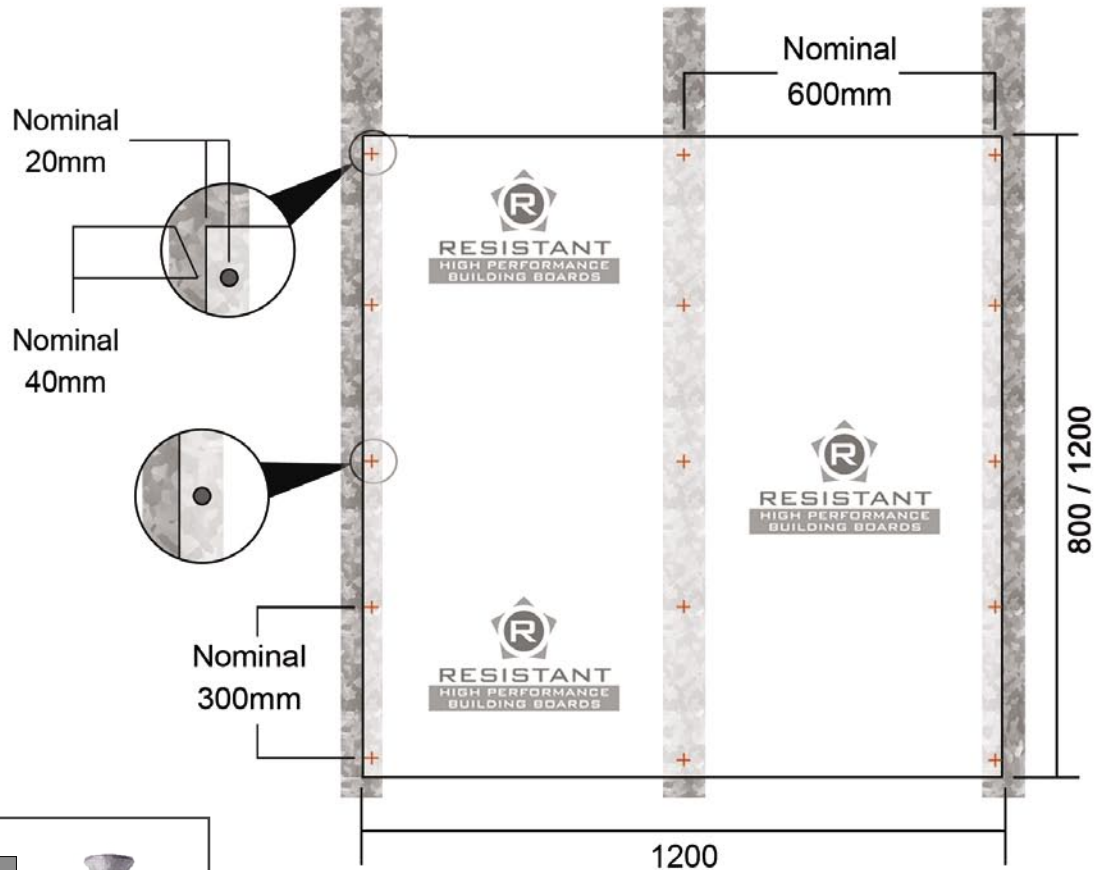

Steel Stud

Case hardened
Carbon Steel
'SCREW-Wing'
Self Taping
Countersunk head



Timber Stud

Wood Screws
Self Taping
Countersunk head

